



**SA**  
**K-SERIES**  
P E R F E C T

## **Instruction Manual**

To ensure maximum performance and safety, please follow this manual. Please retain the manual for future reference after installation.

## **Introduction**

This instruction manual is for your safety and must be adhered to at all times. Please read ensure that you fully understand the installation and set up procedures as explained and if you are unsure on the installation or set up of your VIBE SA-k Series components/ coaxials please contact your nearest authorised VIBE dealer.

## **Contents**

2x SA-k series speakers  
2x Plastic half bullet cones  
2x Flush mount tweeter pods  
2x Surface mount tweeter pods  
2x Mesh grills  
2x VIBE grill badges  
8x Black adhesive pads  
8x Screws  
2 lengths of wire with in line crossovers  
Cut out template

## **Standard Features**

Aluminium Dome Tweeters for superior high frequency response  
Pivoting Tweeters for directional sound  
Interchangeable Tweeter for component or coaxial set-up  
Kevlar Woofer for increased cone stiffness sensitivity  
Gold Plated Terminals  
Polyurethane Surround for improved damping and resistance to ultraviolet rays for longer life  
Kapton Voice Coil Former for higher power handling and increased durability  
In Line Crossover  
Flush and Surface Mount Tweeter Pods

## **WARNING**

DO NOT EXPOSE THIS PRODUCT TO DAMP OR MOISTURE - doing so may result in fire, shock or damage to the product.  
BEFORE WIRING DISCONNECT THE CABLE FROM THE POSITIVE BATTERY TERMINAL - failure to do so may result in electric shock or injury.  
ENSURE GOOD AND CORRECT CONNECTIONS - failure to make the correct connections may result in fire or damage to the product.  
DO NOT USE FUNCTIONS OF THIS EQUIPMENT THAT MAY TAKE YOUR CONCENTRATION AWAY FROM DRIVING YOUR VEHICLE - do not set up your amplifier whilst driving, doing so may result in an accident. For prolonged setting up, make sure that your vehicle is stationary and in a safe location.  
KEEP THE VOLUME AT A LEVEL SO YOU CAN STILL HEAR OUTSIDE NOISE - failure to do this may result in an accident. VIBE equipment is capable of producing sound levels that can permanently damage your hearing. VIBE recommends caution when listening at high volume. For safe and enjoyable listening the sound should be comfortable and clear without distortion.

## **CAUTION**

Never connect any speaker lead to the car chassis. This can cause severe damage to your speaker /car radio /amplifier.

Before drilling or cutting any holes, investigate the layout of your vehicle thoroughly.

Use caution when working near the hydraulic lines and electrical wiring.

Observe the correct polarity when wiring, improper phasing may cause a loss of bass response.

Ensure that no moving parts catch on the speaker or grill (e.g. window or door handles, or window glass inside the door)



## **Installation**

The quality of the installation will affect the system performance and reliability. Contact your nearest authorised VIBE dealer if you are unsure on the installation of this product.

Please be sure to mount this unit away from any potential hazards.

Minimising the length of wires will provide higher audio output from the system.

The speaker should be securely fastened to the mounting position using the screws provided.

Predrill your mounting holes using a drill and position with the template provided.

Be sure to investigate your mounting area thoroughly for electrical wires, vacuum lines, brake or fuel lines or fuel tank to prevent causing any damage.

Firstly make sure that the speakers will fit in your chosen location. This may involve the removal of the standard vehicle speakers. Please use the mounting depth and hole cut dimensions as detailed in this manual for guidance.

Decide whether the SA-k Speaker is to be used as a component set (separate woofer and tweeter) or a coaxial (combined as one unit).

## For Coaxial Fitment

- Cut if necessary any material to allow the correct seating of the speaker, using the hole cut out template enclosed.
- If using grill ensure the plastic ring is seated behind the speaker at this point.
- Connect wires from the crossover unit marked HF to the tweeter. Making sure to connect to the correct polarity
- Connect wires from the crossover unit marked LF to the woofer. Making sure to connect to the correct polarity
- Predill your mounting holes using a drill and position with the template provided.
- Securely screw the speaker in place using the screws provided. Ensure that no wires are trapped.
- Place 4 of the supplied adhesive pads around the grill edge .
- Finally push grill carefully into place.

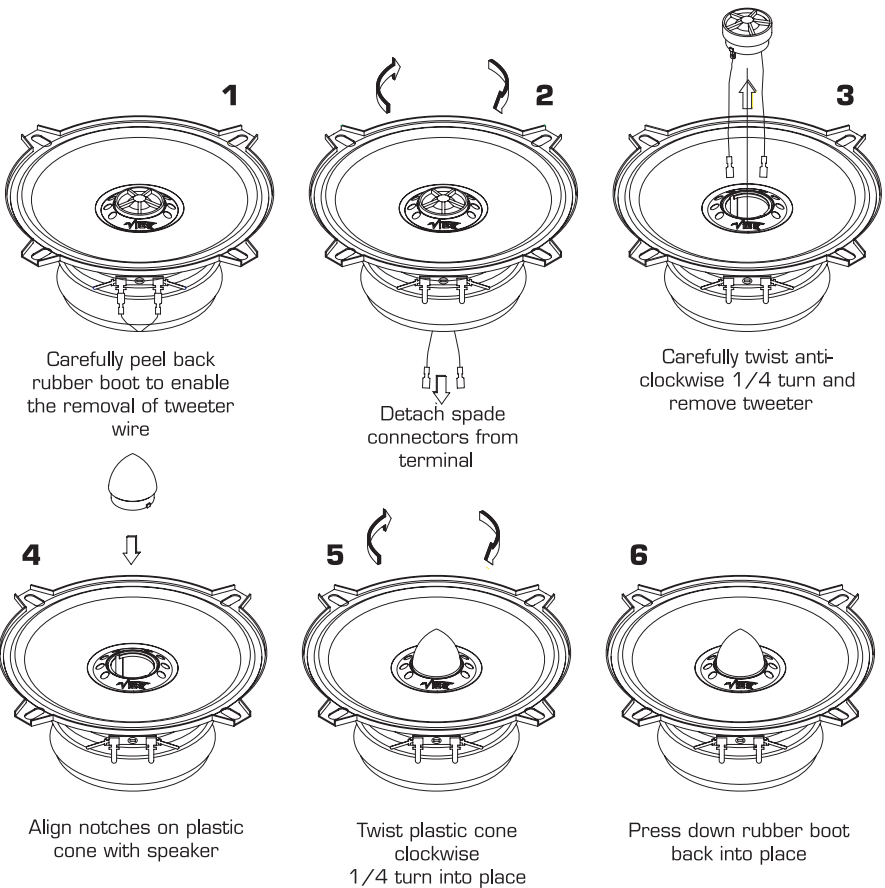

## For Flush Mount Component Fitment

- Follow steps 1 and 2 as detailed before in coaxial fitment for the positioning of the woofer.
- Locate a suitable position for the in line crossover unit. This should not interfere with any moving parts.
- Locate a suitable position for the tweeter. Many positions will provide good sound quality. For optimum staging, position tweeter higher than woofer but within 5" to 10" of the woofer.
- $\Sigma$  For flush mount fitment use the hole cut out template as specified for the tweeter on the cut out template. Check that when the tweeter is in place it will not obstruct or interfere with any handles or moving parts.
- Carefully cut out hole.
- Following instructions below, mount tweeter in flush mount pod and push into place.
- Connect wires from the crossover unit marked HF to the tweeter. Making sure to connect to the correct polarity
- Connect wires from the crossover unit marked LF to the woofer. Making sure to connect to the correct polarity
- Run and connect input wire to music source i.e. head unit or amplifier. Make sure that the source is turned off before making this connection to avoid damage to the equipment.

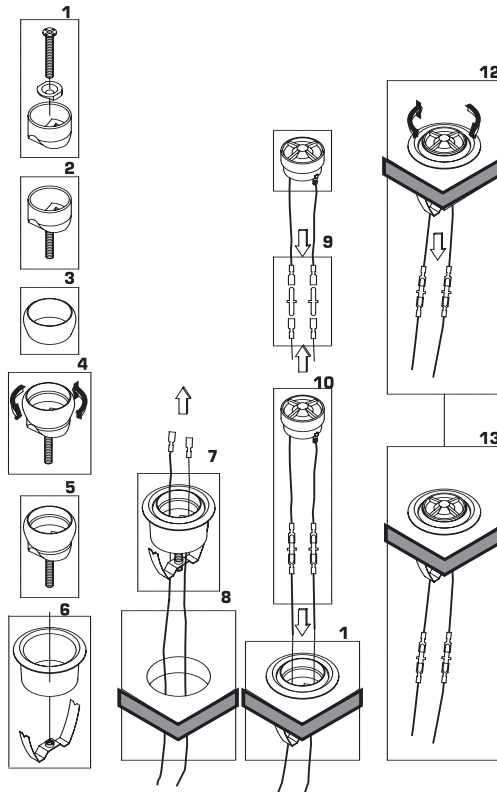

## For Surface Mount Component Fitment

- Follow steps 1 and 2 as detailed before in coaxial fitment for the positioning of the woofer.
- Locate a suitable position for the in line crossover unit, this should not interfere with moving parts.
- Locate a suitable position for the tweeter. Many positions will provide good sound quality. For optimum staging, position tweeter higher than woofer but within 5" to 10" of the woofer.
- For surface mount fitment use the hole cut out template as specified for the tweeter on the cut out template. Check that when the tweeter is in place it will not obstruct or interfere with any handles or moving parts.
- Carefully cut out hole.
- Following instructions below, mount tweeter in surface mount pod and push into place. Position tweeter in flush pod and push into place making sure that the wires are behind the tweeter.
- Connect wires from the crossover unit marked HF to the tweeter. Making sure to connect to the correct polarity.
- Connect wires from the crossover unit marked LF to the woofer. Making sure to connect to the correct polarity.
- Connect input wire to music source i.e. head unit or amplifier. Make sure that the source is turned off before making this connection to avoid damage to the equipment.

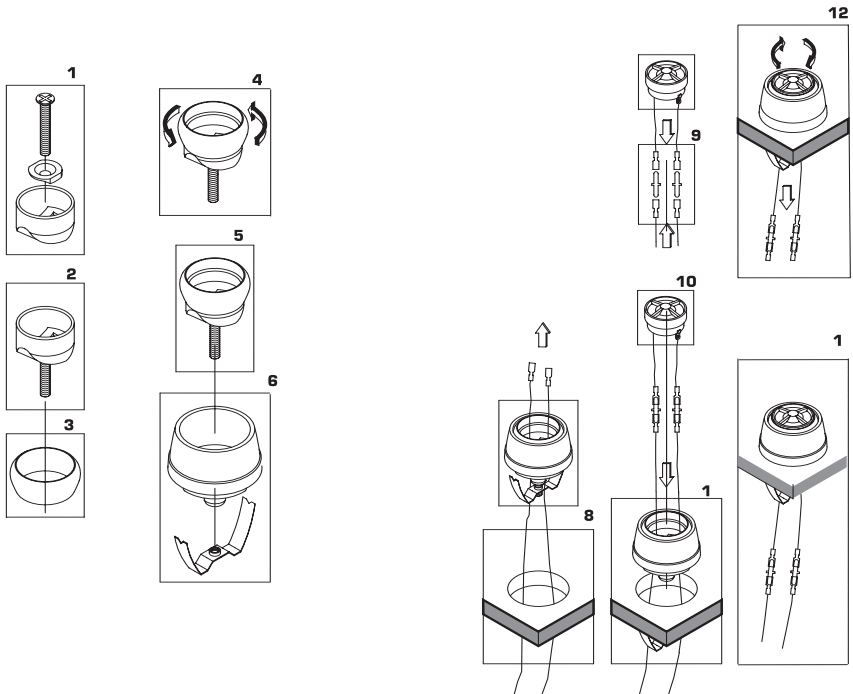

# SA

## K-SERIES

P E R F E C T

### Specifications

Model	SAk50	SAk60
Speaker Size	5.25" (130 mm)	6.5" (165 mm)
RMS Power	85 Watts	90 Watts
Peak Power	255 Watts	270 Watts
Sensitivity 1watt/1metre	89.5 dB	90 dB
Frequency Range	60 Hz- 20 kHz	55 Hz- 20 kHz
Impedance	4 Ohms	4 Ohms
Mounting Depth	55 mm	62 mm
Speaker Hole Cut Out	120mm	143 mm
Resonant Frequency (Fs)	101 Hz	77 Hz
Mechanical Q (Qms)	4.0	5.3
Electrical Q (Qes)	0.8	0.9
Total Q (Qts)	0.65	0.75
Xmax (linear)	0.039"	0.082"
Xmax (mechanical)	0.2655"	0.2840"
Effective Piston Area (Sd)	0.0088 m <sup>2</sup>	0.0132 m <sup>2</sup>
Acoustic Compliance (Vas)	0.19 cu ft	0.43 cu ft
Moving Mass (Mms)	5.04 grams	8.6 grams
Suspension Compliance (Cms)	484 mm/N	493 mm/N
Motor Strength (BL)	3.86 TM	4.41 TM
Voice Coil Diameter (d)	1"	1"
Voice coil length (hvc)	0.276"	0.32"
Voice coil layers (n)	2	2
Voice coil type	Kapton	Kapton
Magnet OD	3.15"	3.15"
Magnet Thickness	0.59"	0.59"
Magnet Weight	10 oz	10 oz
Frame OD	5.13"	6.62"
Speaker Weight	1.44 lbs	1.66 lbs
Driver Displacement	13.86 in <sup>3</sup>	27 in <sup>3</sup>
High-pass/slope	5k/-12 Hz/dB	5k/-12 Hz/dB
Low-pass/slope	Pass	Pass
Recommended VIBE Amplifier	BlackBox1 /2/3	BlackBox1 /2/3



#### Copyright

All content included in this manual such as text, graphics, logos, icons, images, data, is the property of VIBE Technologies Ltd. and is protected by United Kingdom and International copyright laws.

#### Trademarks

VIBE, Turbo Port, Pressure Board, Super Driver, VIBE Pulse, VIBE Power, VIBE Digital, VP1, VP2, VP3, VP4 are all trademarks of VIBE. graphics, logos, are trademarks or trade dress of VIBE Technologies Ltd or its subsidiaries. VIBE's trademarks and trade dress may not be used in connection with any product or service that is not VIBE's, in any manner that is likely to cause confusion among customers, or in any manner that disparages or discredits VIBE.

All other trademarks not owned by VIBE or its subsidiaries that appear in this manual are the property of their respective owners, who may or may not be affiliated with, connected to, or sponsored by VIBE or its subsidiaries.

#### DISCLAIMER

VIBE DOES NOT REPRESENT OR WARRANT THAT THE INFORMATION CONTAINED IN THIS MANUAL IS COMPLETE OR CURRENT, AND THAT ALL SPECIFICATIONS AND INFORMATION CONTAINED WITHIN THIS MANUAL ARE SUBJECT TO CHANGE WITHOUT NOTICE. VIBE RECOMMEND CAUTION WHEN LISTENING TO MUSIC REPRODUCED THROUGH VIBE EQUIPMENT. VIBE EQUIPMENT IS CAPABLE OF PRODUCING SOUND AND SOUND PRESSURE LEVELS THAT CAN PERMANENTLY DAMAGE HEARING OF YOU AND THAT OF OTHERS. FOR SAFE AND ENJOYABLE LISTENING, THE SOUND SHOULD BE CLEAR WITHOUT DISTORTION AT A COMFORTABLE VOLUME. BY USING ANY VIBE EQUIPMENT, YOU AGREE TO TAKE FULL RESPONSIBILITY FOR YOUR OWN SAFETY AND THE SAFETY OF OTHERS WHEN LISTENING TO MUSIC AT HIGH VOLUMES THROUGH EQUIPMENT YOU HAVE PURCHASED. USE OF ANY VIBE EQUIPMENT CONSTITUTES AGREEMENT TO THIS DISCLAIMER.